



NOTA:
- Toate fisurile si degradarile intalnite pe fetele de beton existente se vor remedia cu injectari cu mortare speciale sau rasini epoxidice;
- Toate elementele de beton vor fi protejate anticoroziv;

 INVESTITOR COMPANIA NATIONALA DE ADMINISTRARE A INFRASTRUCTURII RUTIERE S.A.	 PROIECTANT GENERAL D.P. CONSULT S.A.	 AMPLASAMENT	DENUMIRE PROIECT PROIECTARE SI EXECUTIE "VARIANTA DE OCOLIRE TIMISOARA SUD" ELABORARE PROIECT TEHNIC REST DE EXECUTAT NUMAR CONTRACT: 550/36/09.02.2023 NUMAR PROIECT : 556	FAZA PROIECT PROIECT TEHNIC REST DE EXECUTAT Data : 03.2023 VERIFICATOR TEHNIC	Manager de Proiect ing. Silivan Moldovan Sef Echipa Proiectare ing. Raul Cocis Inginer Proiectant Poduri ing. Attila Takacs Inginer Proiectant ing. Teodor Sabadis	REVIZII			DENUMIRE PLANSA PASAJ KM 3+509 (3+517) PESTE CONDUCTE DE GAZ SI DRUM TEHNOLOGIC RELEVU Scara : 1:100 1:200 NUMAR PLANSA 10036-VOTM-STR03-RLE-01
						NR. REV.	DATA	SEMN.	

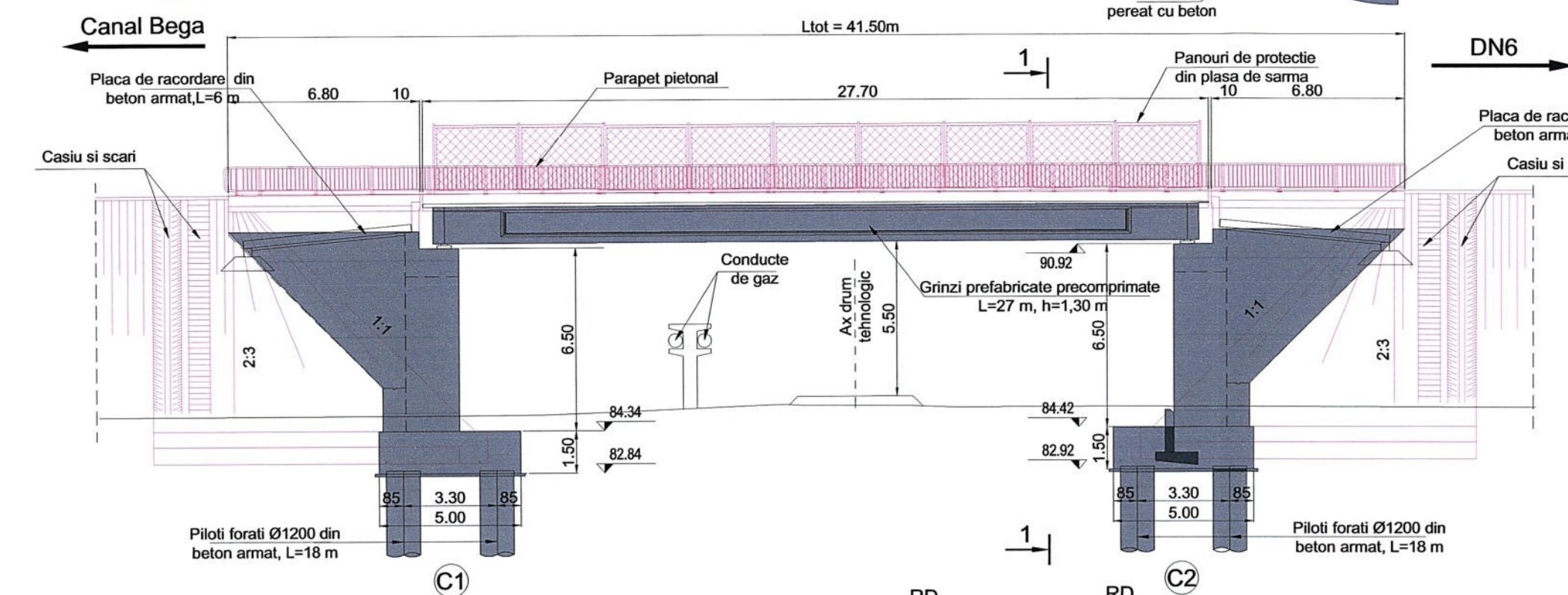
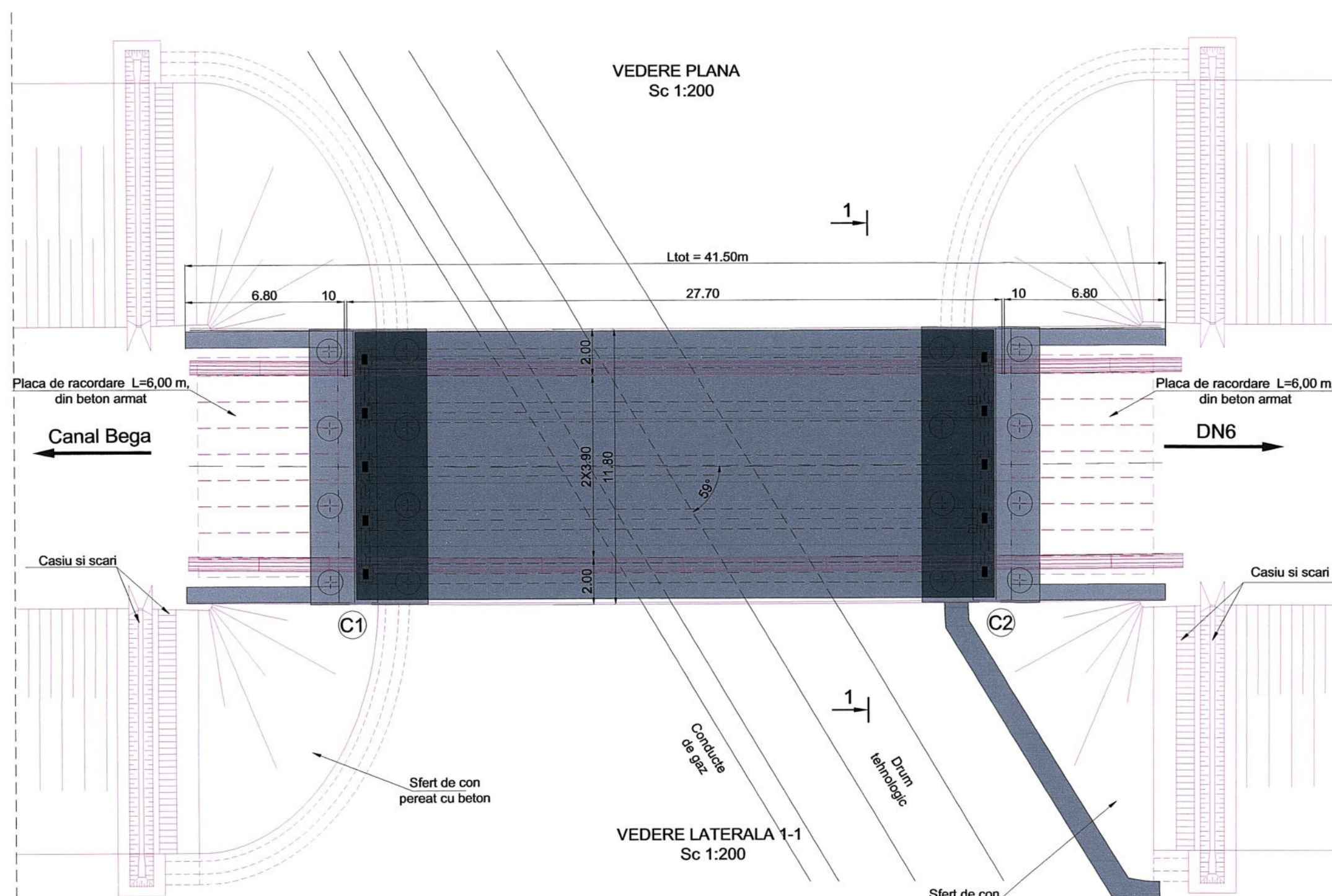

Convoitul de calcul: LM1, LM2(SR EN 1991-2/2005).
Caracteristicile seismice ale zonei: ag=0.2g, Tc=0.7 s
conform cod P100/1-2013, SR EN 1998-2/2006.
Categoria de importanta: C.
Exigente de verificare: A4, B2, D2.

RD Δ=min±20mm
RD Δ=min±20mm
RM 26.20 RF
RN RN
C1 C2
RN - aparat de reazem din neopren
RF - aparat de reazem fix
RM - aparat de reazem mobil

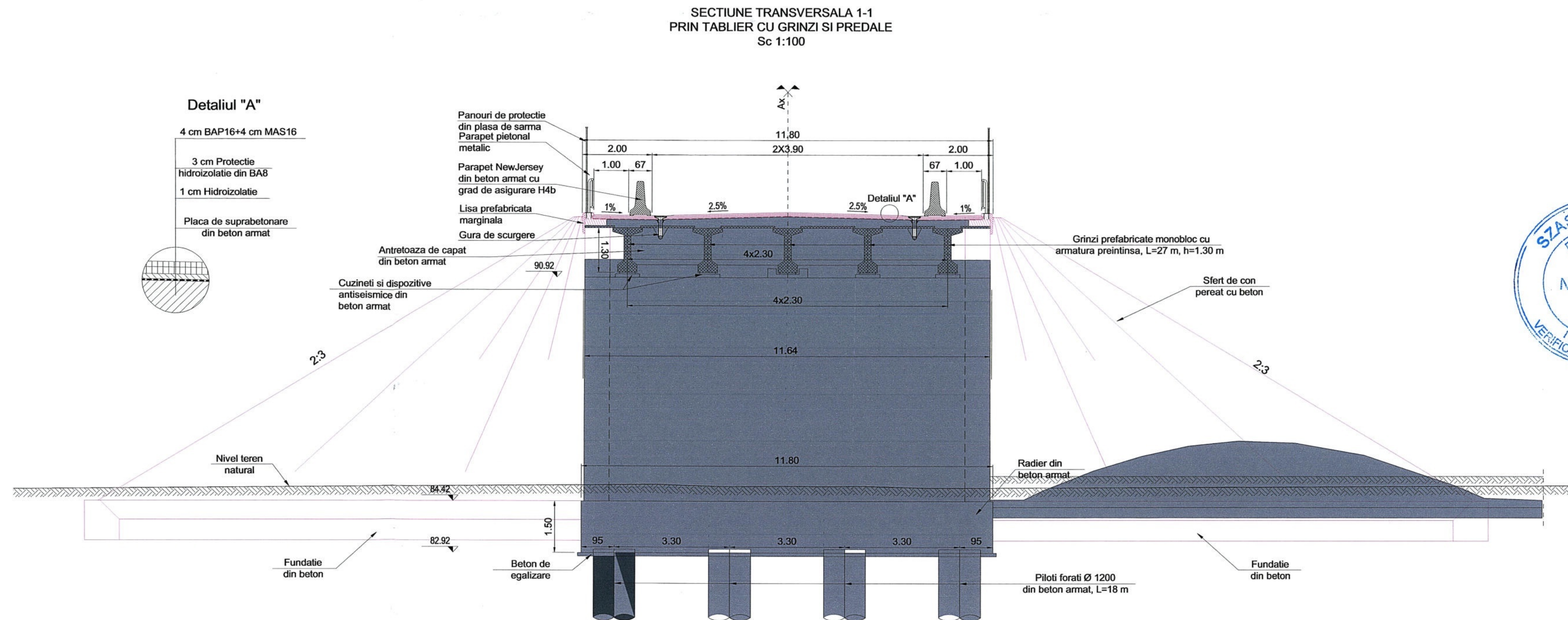
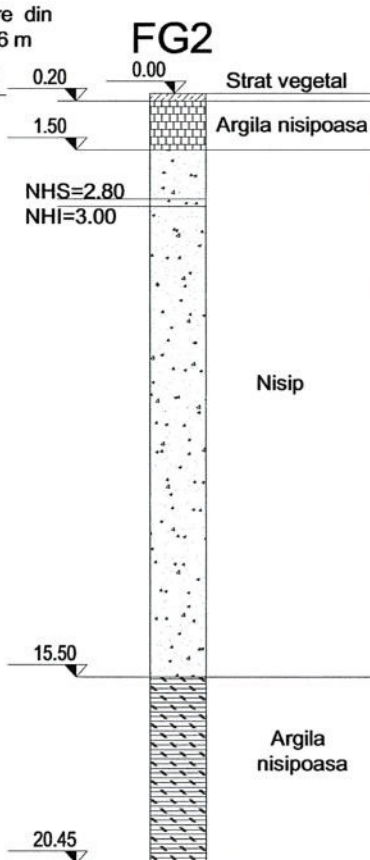

NOTA:
- Toate fisurile si degradarile intalnite pe fetele de beton existente se vor remedia cu injectari cu mortare speciale sau rasini epoxidice;
- Toate elementele de beton vor fi protejate anticoroziv;

INVESTITOR COMPANIA NATIONALA DE ADMINISTRARE A INFRASTRUCTURII RUTIERE S.A.	PROIECTANT GENERAL D.P. CONSULT S.A.	AMPLASAMENT	DENUMIRE PROIECT PROIECTARE SI EXECUTIE "VARIANTA DE OCOLIRE TIMISOARA SUD" ELABORARE PROIECT TEHNIC REST DE EXECUTAT	FAZA PROIECT PROIECT TEHNIC REST DE EXECUTAT	Manager de Proiect ing. Silvan Moldovan Sef Echipa Proiectare ing. Raul Codis
			NUMAR CONTRACT: 550/36/09.02.2023 NUMAR PROIECT: 556	Data: 03.2023 VERIFICATOR TEHNIC	Inginer Proiectant Poduri ing. Attila Takacs Inginer Proiectant ing. Teodor Sabadis

REVIZII			DENUMIRE PLANSA
NR. REV.	DATA	SEMN.	
			PASAJ KM 3+509 (3+517) PESTE CONDUCTE DE GAZ SI DRUM TEHNOLOGIC, DISPOZITIE GENERALA SOLUTIE PROIECT ACTUALIZAT
			Scara: 1:100 1:200
			NUMAR PLANSA
			10036-VOTM-STR03-DG-01

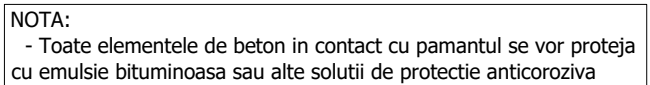

Sc 1:100

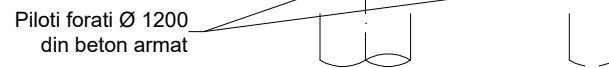

Sc 1:100

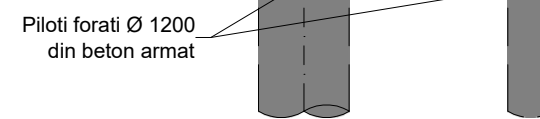

CERINTE DE CALITATE	
BETON EGALIZARE	
Beton:	C8/10
Otel:	-
Clasa de expunere:	-
Valoare max. A/C:	-
Dozaj min. ciment:	-

**CERINTE DE CALITATE
RADIERE/FUNDATII**
Beton: C25/30
Otel: BST500C
Clasa de expunere: XC2, XF3
Valoare max. A/C: 0.55^a
Dozaj min. ciment: 300 Kg/m³

**CERINTE DE CALITATE
ELEVATII**
Beton: C30/37
Otel: BST500C
Clasa de expunere: XC4, XD1
Valoare max. A/C: 0.50
Dozaj min. ciment: 300 Kg/m³

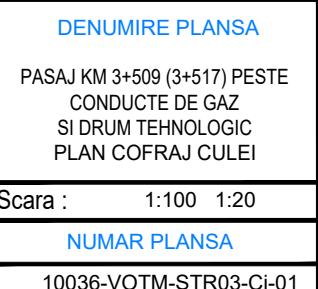

SECTIUNE ELEVATIE

Sc 1:100

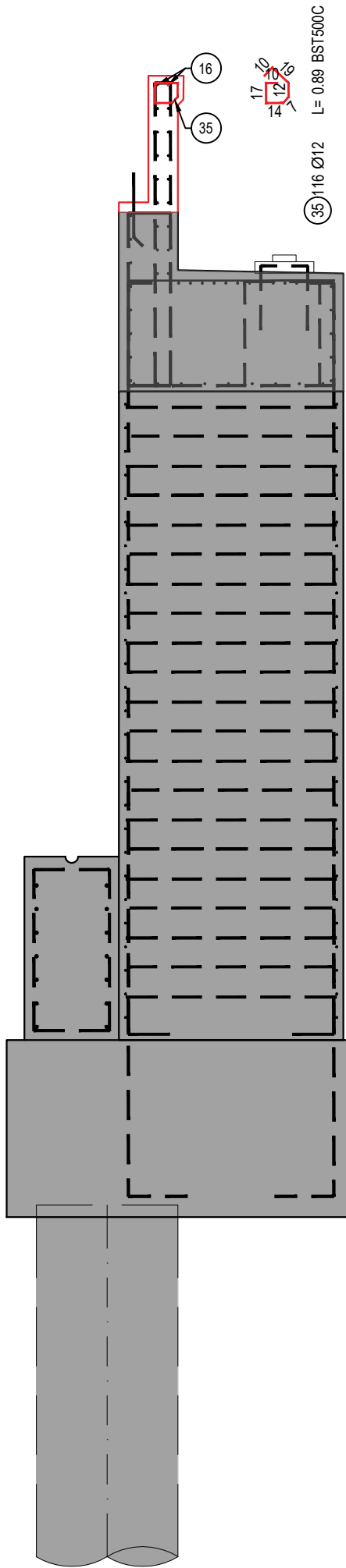

VEDERE LATERALA

Sc 1:100

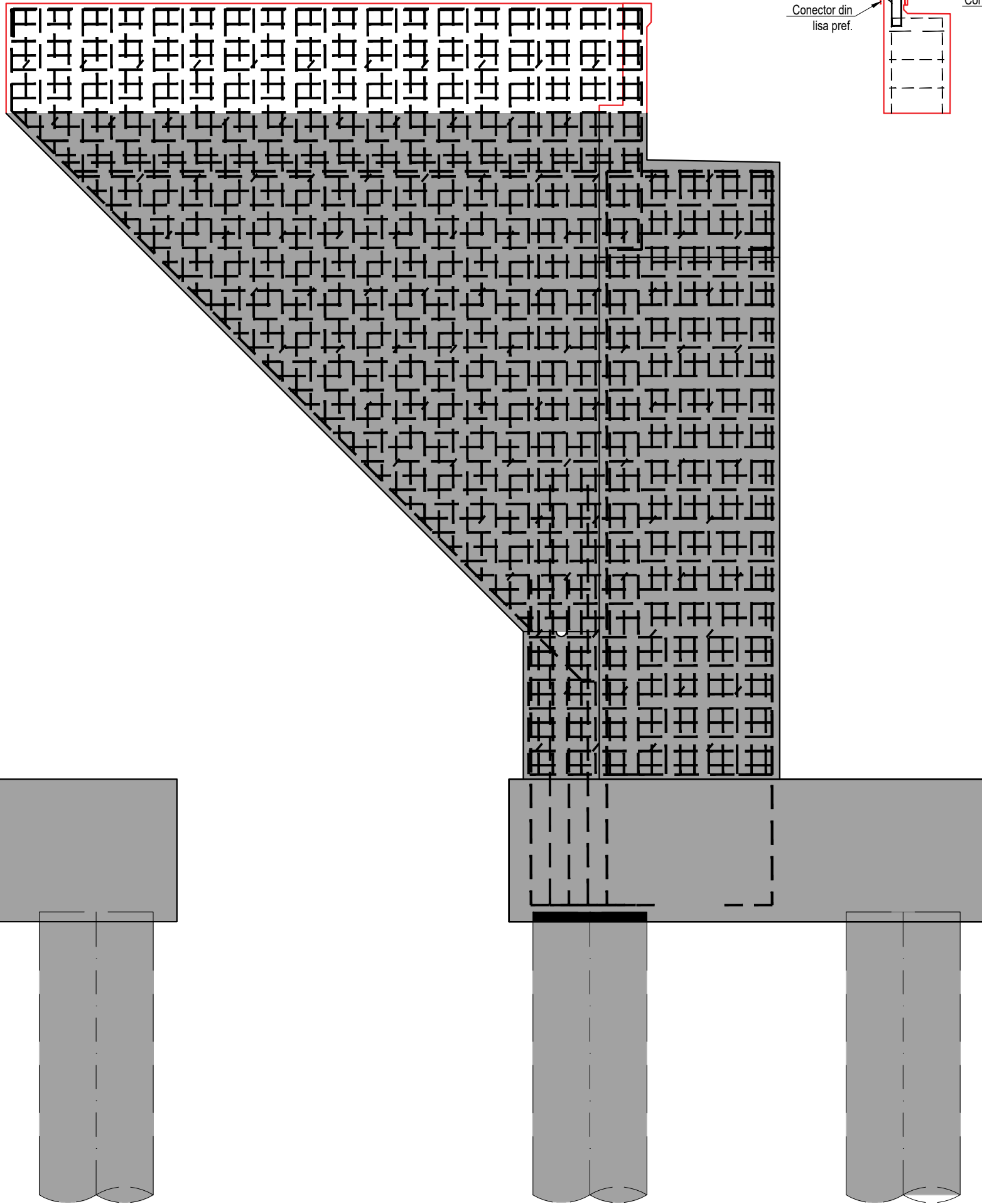

SECTIUNE ZID INTORS

Sc 1:50

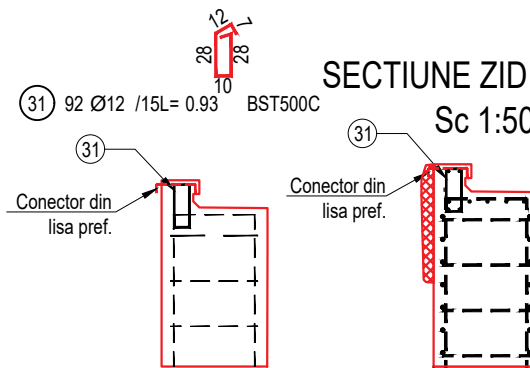

VEDERE DIN FATA

Sc 1:50

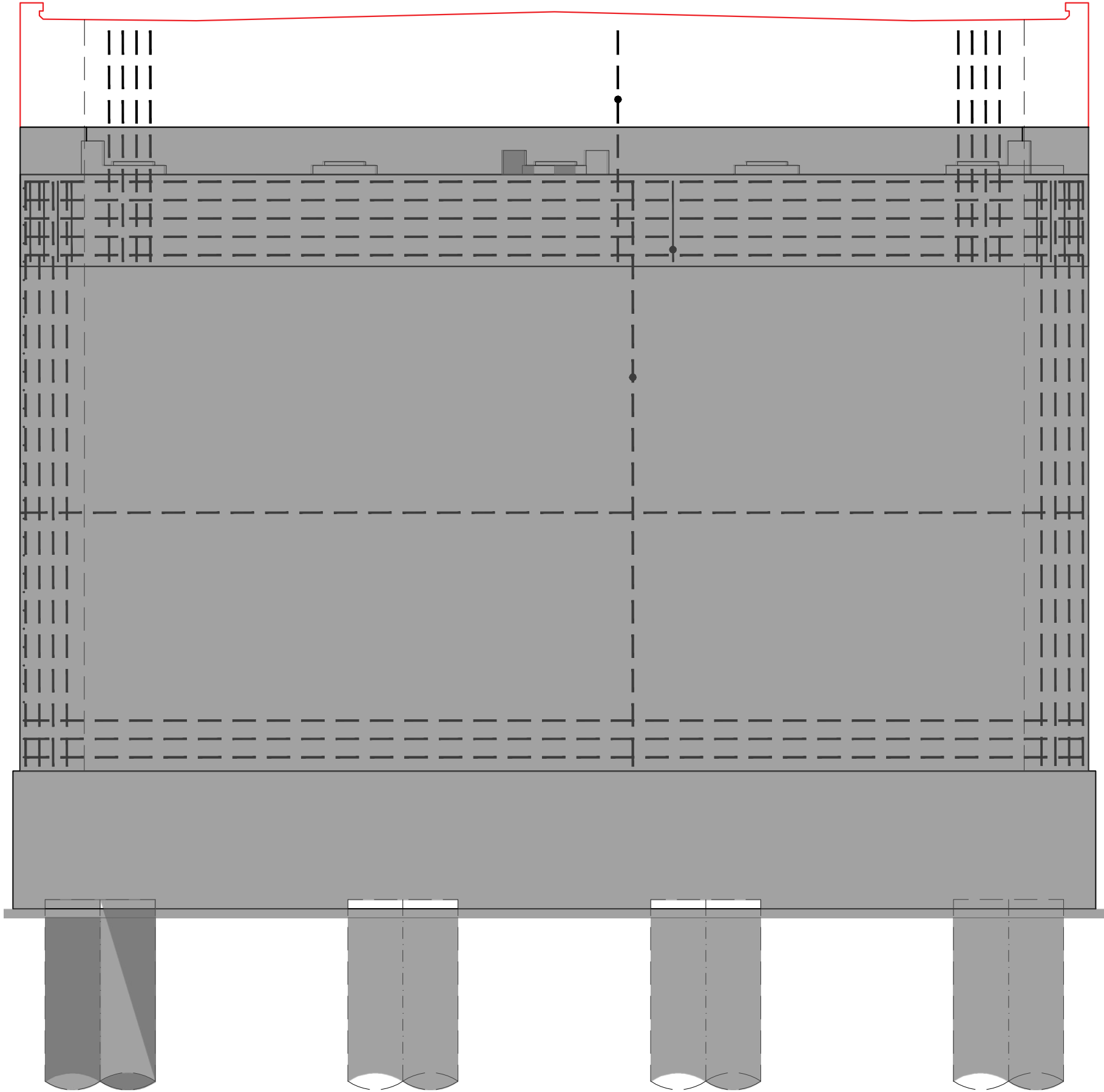

EXTRAS DE ARMARE PENTRU O ELEVATIE CULEE

MARCA	DIAMETRU	NR BUCATI	LUNGIMI [m]	
			/bucata	/diametru BST500C Ø12
16	12	2	11.78	23.56
24	12	8	6.82	54.56
31	12	92	0.93	85.56
35	12	116	0.89	103.24
LUNGIMI TOTALE[m]				266.92
MASA [kg]			/metru	0.889
			/diametru	237.28
			totala	237.28

LEGENDA:

REALIZAT-

NEREALIZAT-

CANTITATEA TOTALA DE ARMATURA				
Nr.crt.	Element	Nr. elemente asemenea	kg / element	TOTAL kg / element
1	ELEVATIE CULEE	2	237.28	474.56

CERINTE DE CALITATE ELEVATII
Beton: C30/37
Otel: BST500C
Clasa de expunere: XC4, XD1, XF2.
Valoare max. A/C: 0.50
Dozaj min. ciment: 300 Kg/m³

INVESTITOR
COMPANIA NATIONALA DE ADMINISTRARE
A INFRASTRUCTURII RUTIERE S.A.

PROIECTANT GENERAL
D P CONSULT S.A.

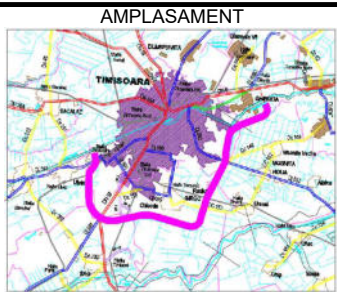

DENUMIRE PROIECT
PROIECTARE SI EXECUTIE
"VARIANTA DE OCULIRE
TIMISOARA SUD"
ELABORARE PROIECT TEHNIC
REST DE EXECUTAT
NUMAR CONTRACT: 550/36/09.02.2023
NUMAR PROIECT : 556

FAZA PROIECT
PROIECT TEHNIC
REST DE EXECUTAT
Data : 03.2023
VERIFICATOR TEHNIC

Manager de Proiect
ing. Silvan Moldovan
Sef Echipa Proiectare
ing. Raul Cocis
Inginer Proiectant Poduri
ing. Attila Takacs
Inginer Proiectant
ing. Teodor Sabadis

REVIZII		
NR. REV.	DATA	SEM.N.

DENUMIRE PLANSA
PASAJ KM 3+509 (3+517) PESTE
CONDUCTE DE GAZ SI DRUM
TEHNOLOGIC, PLAN ARMARE
ELEVATIE CULEE
Scara : 1:50
NUMAR PLANSA
10036-VOTM-STR03-AI-03

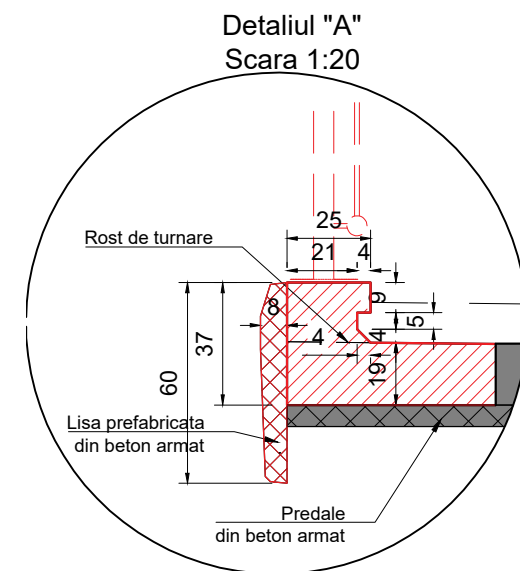
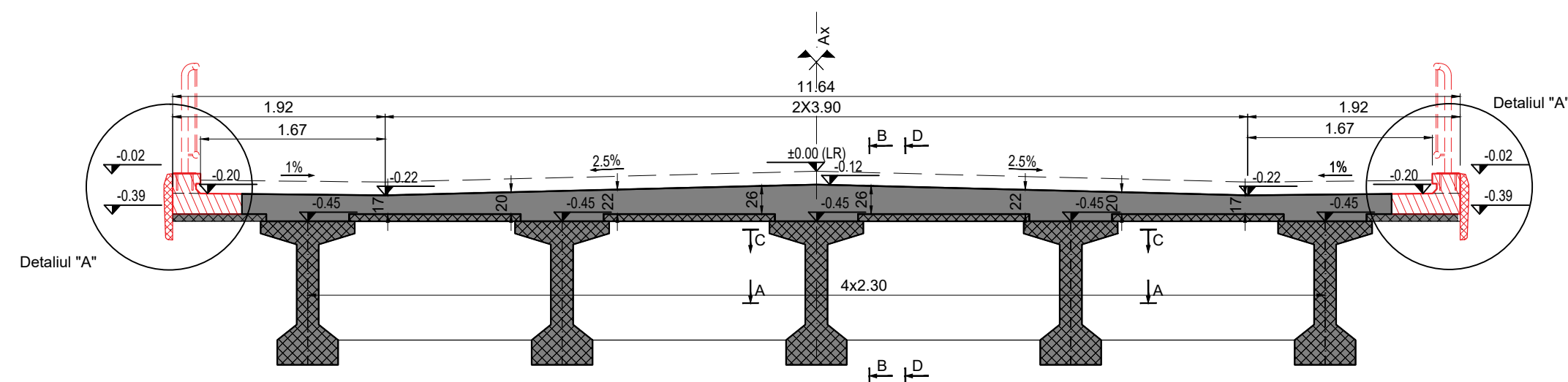
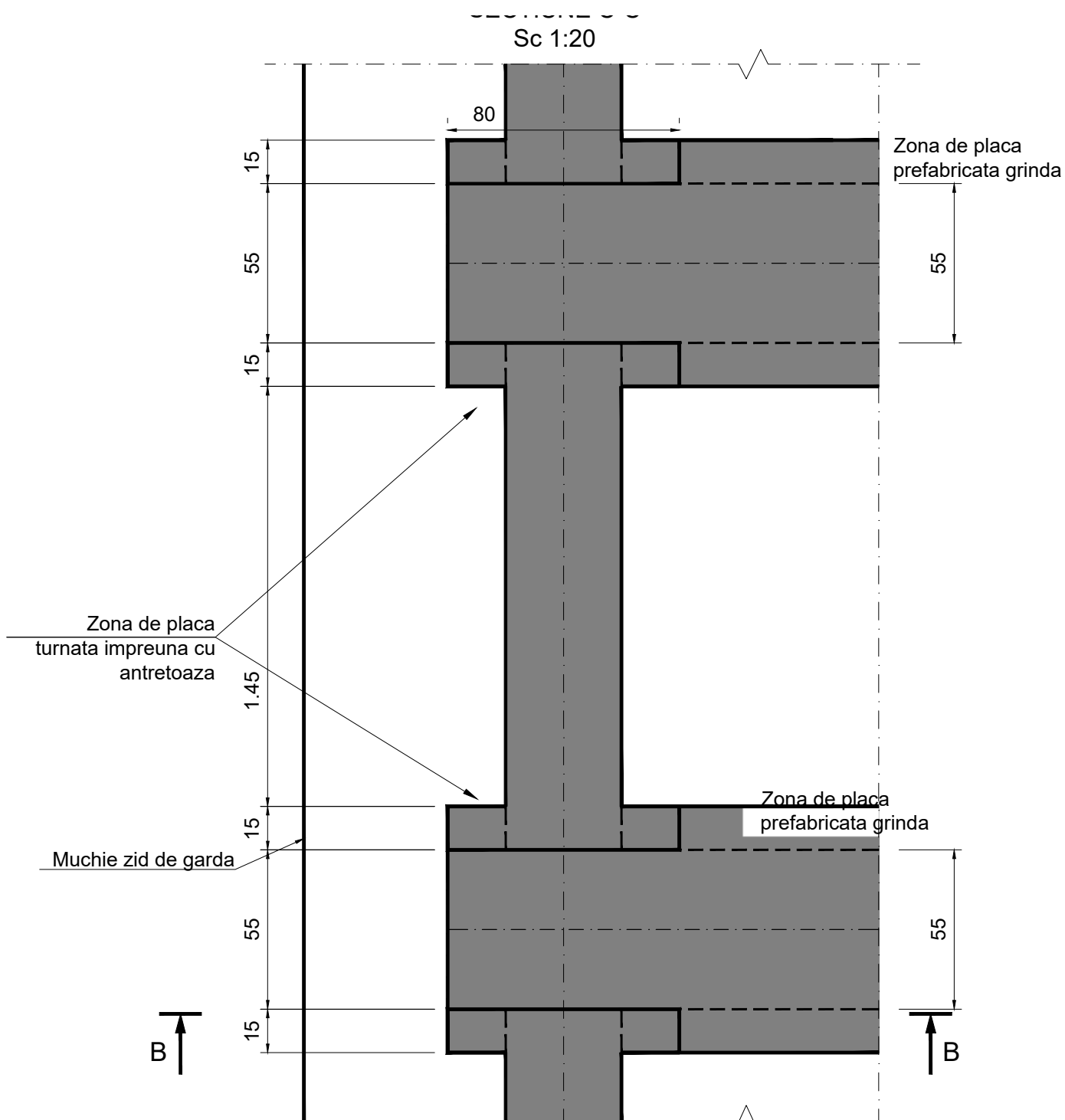
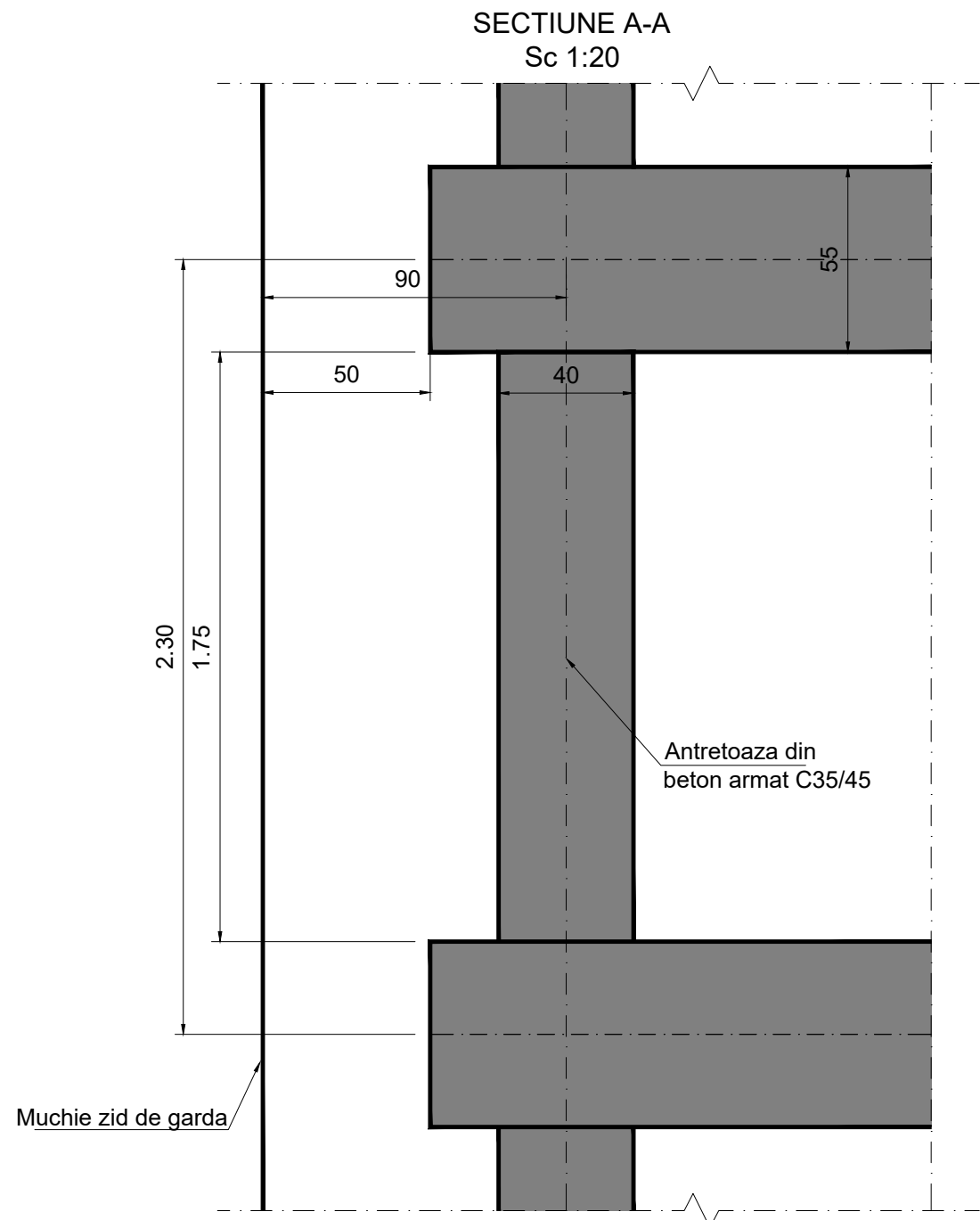
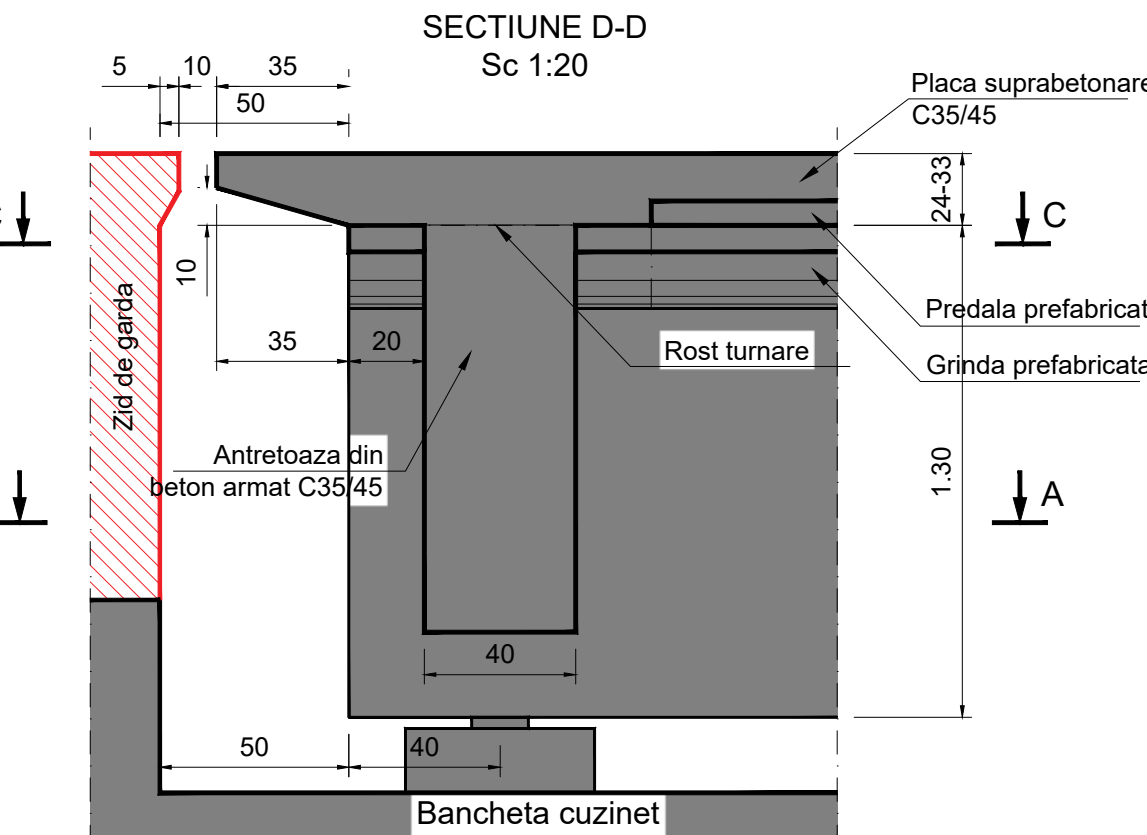
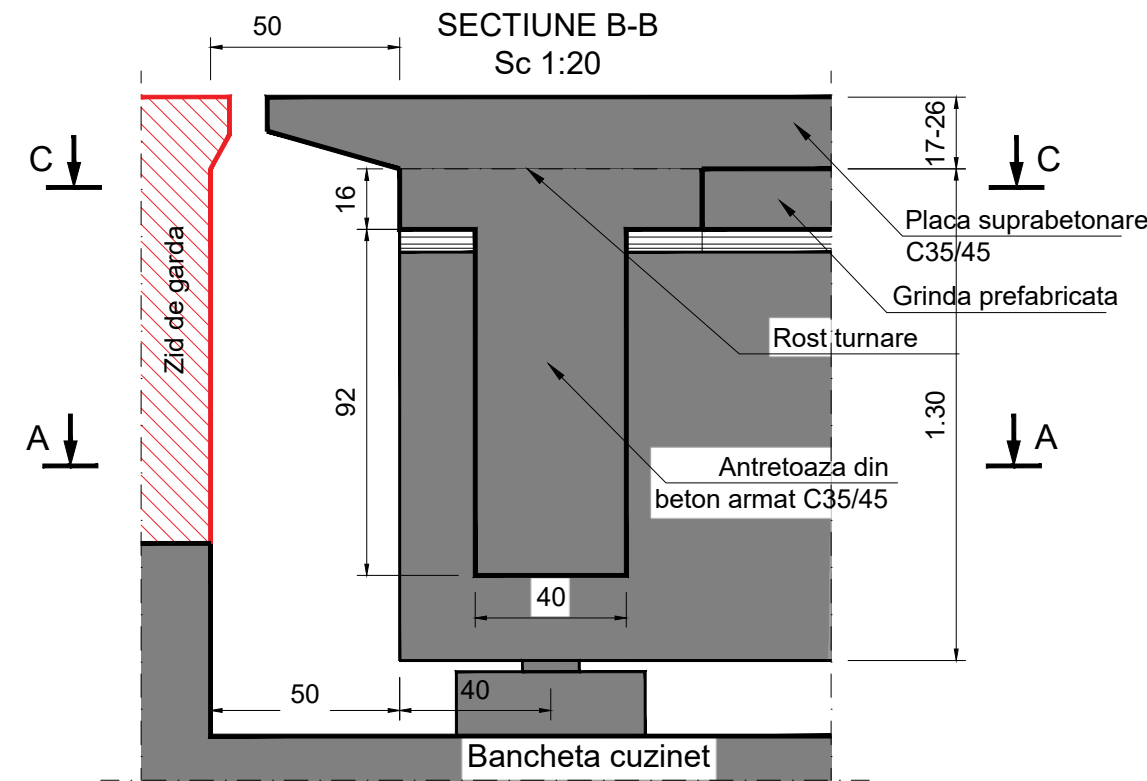

SECTIUNE LONGITUDINALA
ZONA DE CAPAT DE PE CULEI
SCARA 1:20

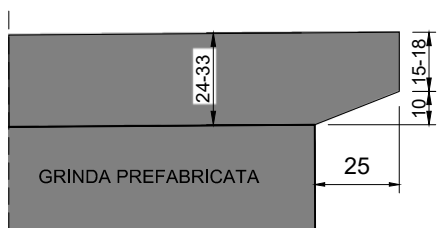

LEGENDA:

REALIZAT-

NEREALIZAT-

CERINTE DE CALITATE
PREDALE

Beton: C35/45
Otel: BST500C
B450C
Clasa de expunere: XC4, XD1, XF2.
Valoare max. A/C: 0.55
Dozaj min. ciment: 300 Kg/m³

CERINTE DE CALITATE
ANTRETOAZA

Beton: C35/45
Otel: BST500C
Clasa de expunere: XC3, XF2
Valoare max. A/C: 0.55
Dozaj min. ciment: 340 Kg/m³

CERINTE DE CALITATE
PLACA DE SUPRABETONARE

Beton: C35/45
Otel: BST500C
Clasa de expunere: XC3, XD1, XF2
Valoare max. A/C: 0.55
Dozaj min. ciment: 340 Kg/m³



PROIECTANT GENERAL

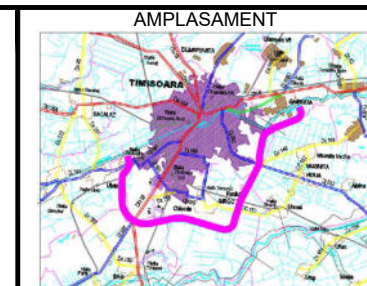

DENUMIRE PROIECT
PROIECTARE SI EXECUTIE
"VARIANTA DE OCOLIRE
TIMISOARA SUD"
ELABORARE PROIECT TEHNIC
REST DE EXECUTAT

NUMAR CONTRACT: 550/36/09.02.2023

NUMAR PROIECT : 556

FAZA PROIECT
PROIECT TEHNIC
REST DE EXECUTAT

Data : 03.2023

VERIFICATOR TEHNIC

Manager de Proiect
ing. Silvan Moldovan

Sef Echipa Proiectare
ing. Raul Cocis

Inginer Proiectant Poduri
ing. Attila Takacs

Inginer Proiectant

REVIZII

NR. REV. DATA SEMN.

DENUMIRE PLANSA

PASAJ KM 3+509 (3+517) PESTE
CONDUCTE DE GAZ SI DRUM
TEHNOLOGIC, PLAN COFRAJ
PLACA DE SUPRABETONARE

Scara : 1:50 1:20

NUMAR PLANSA

10036-VOTM-STR03-Cs-01

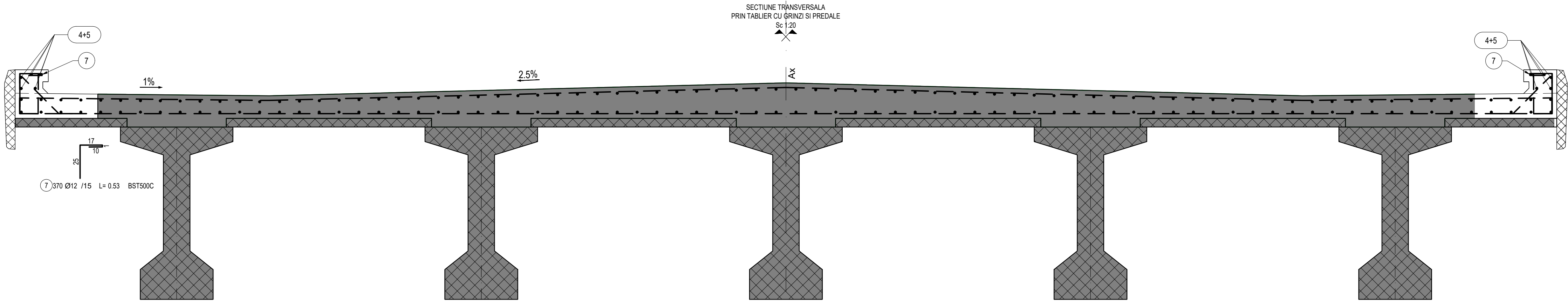

NOTA:

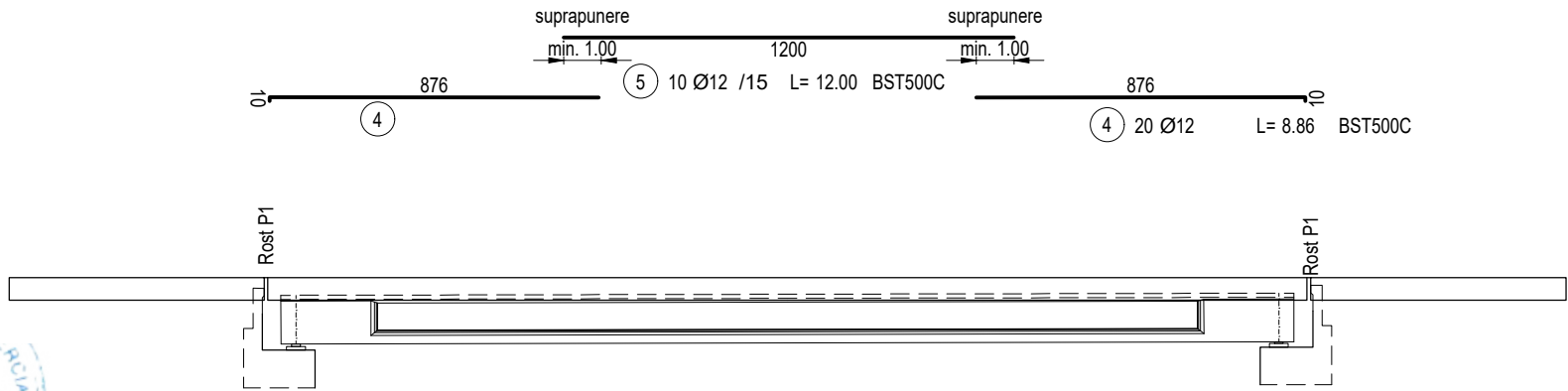

- Acoperirea minima la partea superioara a placii este 3.5cm, iar pe lisa de parapet este de minim 5cm.
- Toate dimensiunile barelor sunt date in ax;
- Constructorul are obligatia de a verifica proiectul inainte de a proceda la executie si de a comunica proiectantului orice nepotrivire, eroare sau neclaritate pentru a face corectiile sau clarificarile necesare.

DISPUNEREA ARMATURILOR LONGITUDINALE PLACA
Sc. 1:200





Extras armatura					
MARCA	DIAMETRU	NR BUCATI	LUNGIMI [m]		
			/bucata	/diametru	
				BST500C	
			Ø12		
4	12	20	8.86	177.20	
5	12	10	12.00	120.00	
7	12	370	0.53	196.10	
LUNGIMI TOTALE[m]				493.30	
MASA [kg]			/metru	0.889	
			/diametru	438.52	
			totala	438.52	

CERINTE DE CALITATE
PLACA DE SUPRABETONARE
Beton: C35/45
Otel: BST500C
Clasa de expunere: XC3, XD1, XF2
Valoare max. A/C: 0.55^a
Dozaj min. ciment: 340 Kg/m³

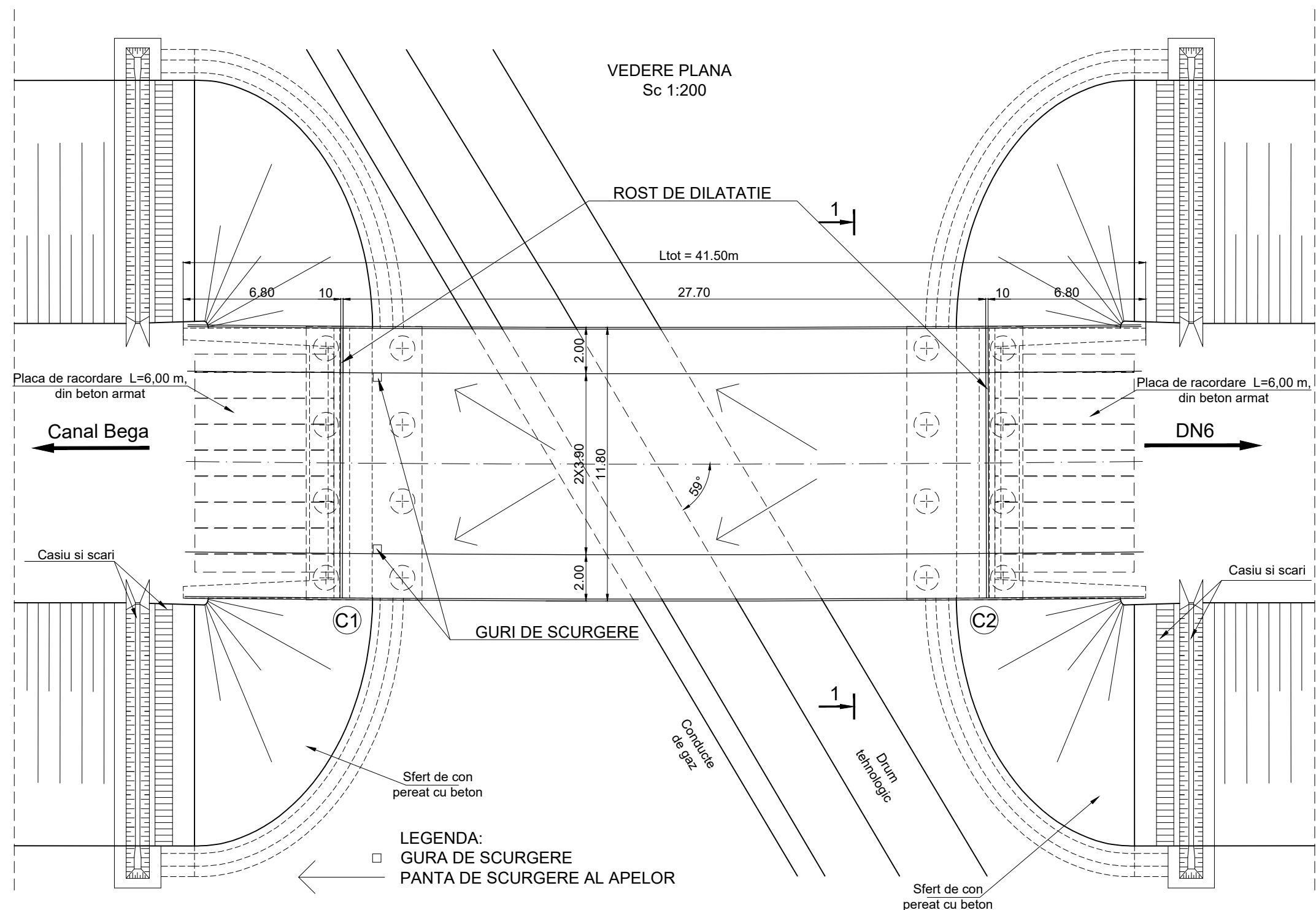
<div>INVESTITOR</div> <div></div> <div>COMPANIA NATIONALA DE ADMINISTRARE A INFRASTRUCTURII RUTIERE S.A.</div>	<div>PROIECTANT GENERAL</div> <div></div> <div>D.P. CONSULT S.A.</div>	<div>AMPLASAMENT</div> <div></div>	<div>DENUMIRE PROIECT</div> <div>PROIECTARE SI EXECUTIE "VARIANTA DE OCOLIRE TIMISOARA SUD" ELABORARE PROIECT TEHNIC REST DE EXECUTAT</div>	<div>FAZA PROIECT</div> <div>PROIECT TEHNIC REST DE EXECUTAT</div>	<div>Manager de Proiect</div> <div>ing. Silivan Moldovan</div> <div>Sef Echipa Proiectare</div> <div>ing. Raul Cocis</div> <div>Inginer Proiectant Poduri</div> <div>ing. Attila Takacs</div> <div>Inginer Proiectant</div> <div>ing. Teodor Sabadis</div>	<div>REVIZII</div> <table><tr><th>NR. REV.</th><th>DATA</th><th>SEMN.</th></tr><tr><td></td><td></td><td></td></tr></table>	NR. REV.	DATA	SEMN.				<div>DENUMIRE PLANSA</div> <div>PASAJ KM 3+509 ARMARE PLACA DE SUPRABETONARE</div> <div>Scara : 1:10, 1:20, 1:100, 1:200</div> <div>NUMAR PLANSA</div> <div>10036-VOTM-STR03-AS-03</div>
NR. REV.	DATA	SEMN.											
<div>NUMAR CONTRACT: 550/36/09.02.2023</div>			<div>Data : 03.2023</div>										
<div>NUMAR PROIECT : 556</div>			<div>VERIFICATOR TEHNIC</div>										



<div>INVESTITOR</div> <div></div> <div>COMPANIA NATIONALA DE ADMINISTRARE A INFRASTRUCTURII RUTIERE S.A.</div>	<div>PROIECTANT GENERAL</div> <div></div> <div>D P CONSULT S.A.</div>	<div>AMPLASAMENT</div> <div></div>	<div>DENUMIRE PROIECT</div> <div>PROIECTARE SI EXECUTIE "VARIANTA DE OCOLIRE TIMISOARA SUD" ELABORARE PROIECT TEHNIC REST DE EXECUTAT</div>	<div>FAZA PROIECT</div> <div>PROIECT TEHNIC REST DE EXECUTAT</div>		<div>Manager de Proiect</div> <div>ing. Silivan Moldovan</div>	<div>REVIZII</div> <table><tr><th>NR. REV.</th><th>DATA</th><th>SEMN.</th></tr><tr><td></td><td></td><td></td></tr><tr><td></td><td></td><td></td></tr><tr><td></td><td></td><td></td></tr></table>	NR. REV.	DATA	SEMN.										<div>DENUMIRE PLANSA</div> <div>PASAJ KM 3+509 (3+517) PESTE CONDUCTE DE GAZ SI DRUM TEHNOLOGIC SCURGEREA APELOR POZITIONARE GURI DE SCURGERE</div> <div>Scara : 1:100 1:200</div> <div>NUMAR PLANSA</div> <div>10036-VOTM-STR03-SA-01</div>
			NR. REV.	DATA	SEMN.															
	<div>Data : 03.2023</div>																			
<div>NUMAR CONTRACT: 550/36/09.02.2023</div>	<div>VERIFICATOR TEHNIC</div>																			
<div>NUMAR PROIECT : 556</div>																				